

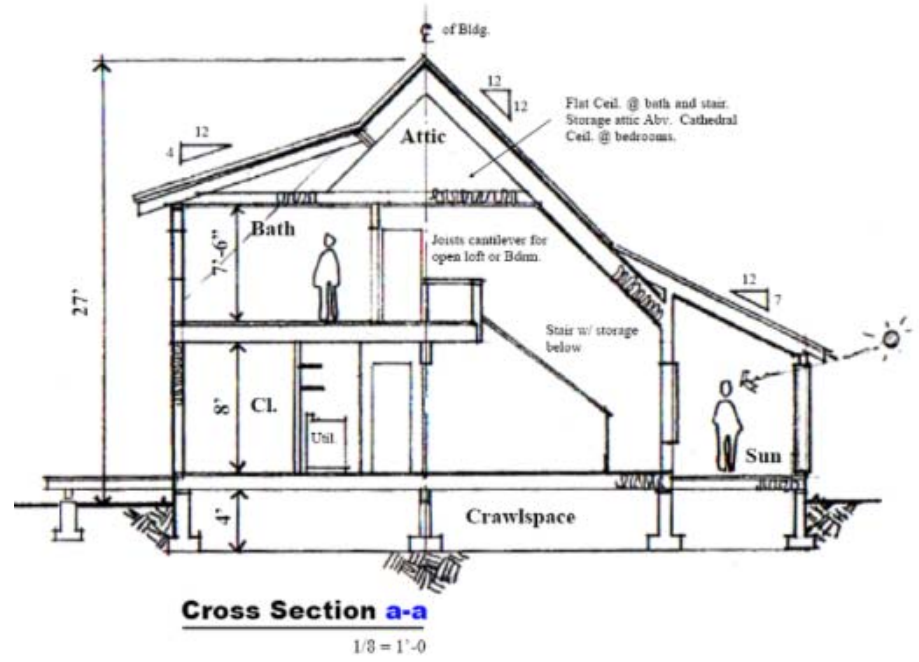

**Latitude affects dominance by  
secondary foundation species on  
red mangrove (*Rhizophora mangle*)  
prop roots**

By Jessene Aquino-Thomas and C. Edward Proffitt

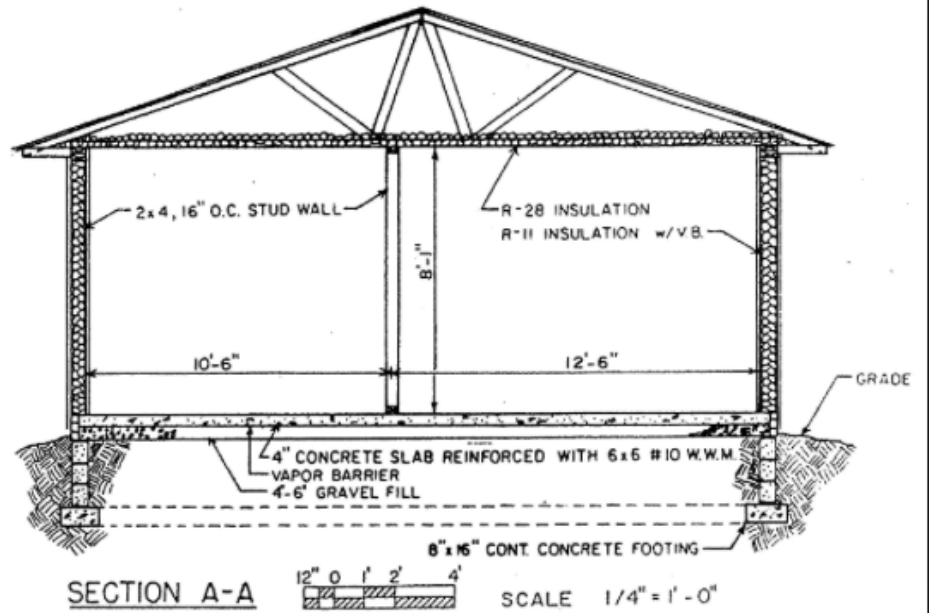

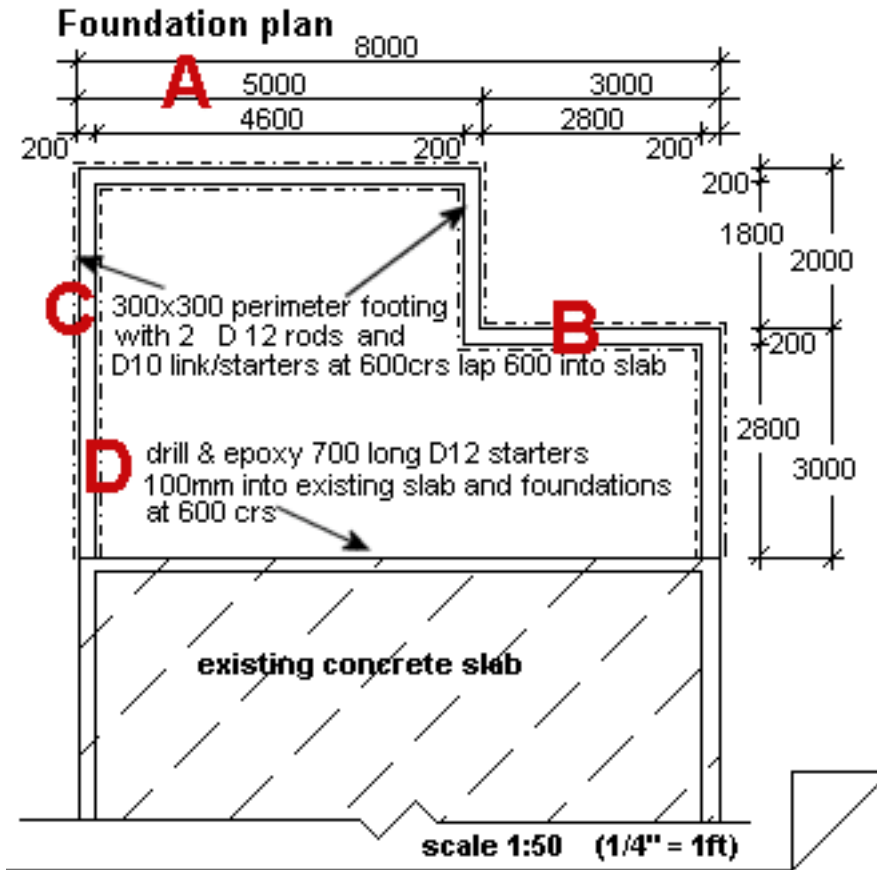
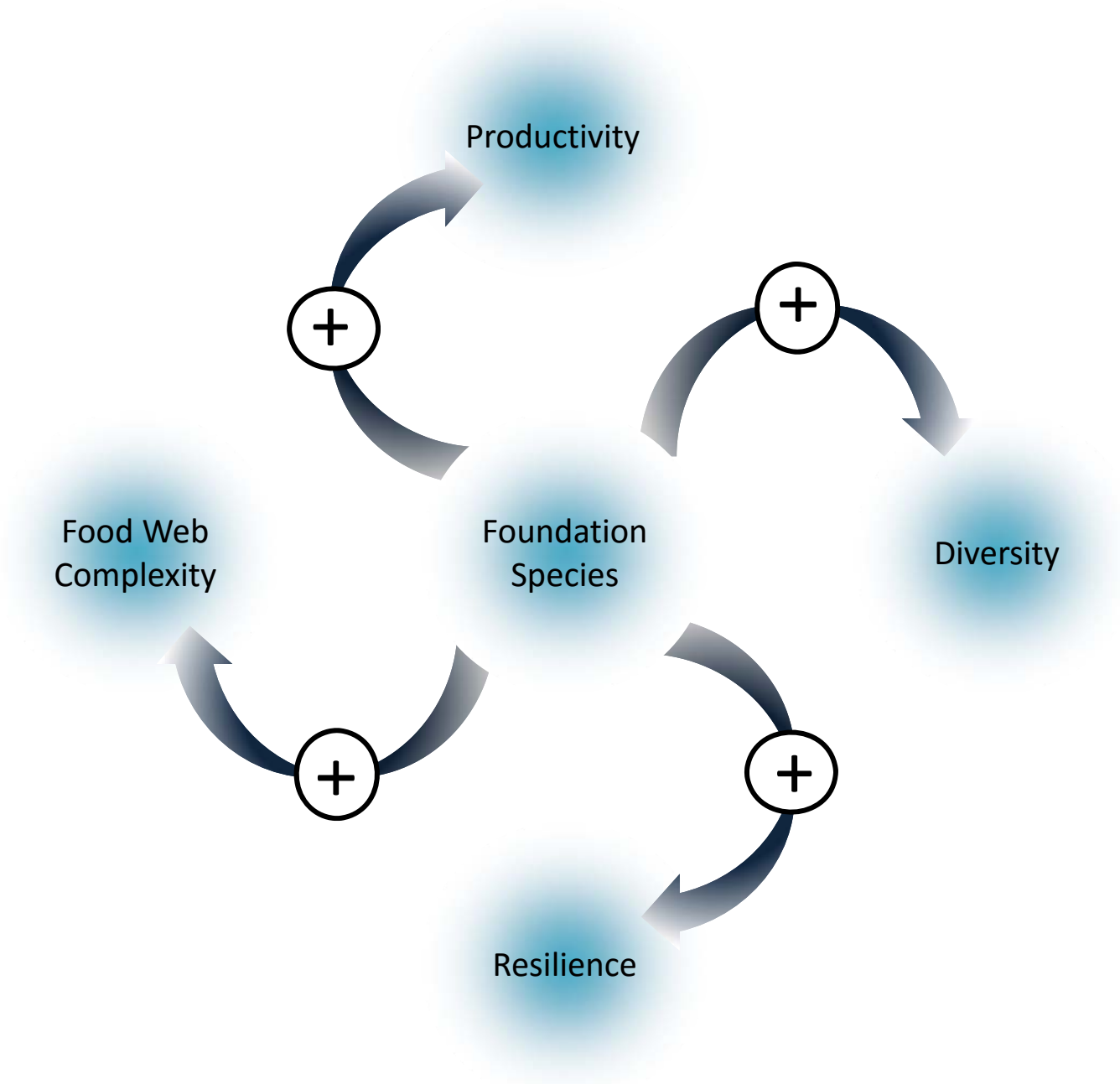



# Foundation Species – Biodiversity

## facilitation cascade

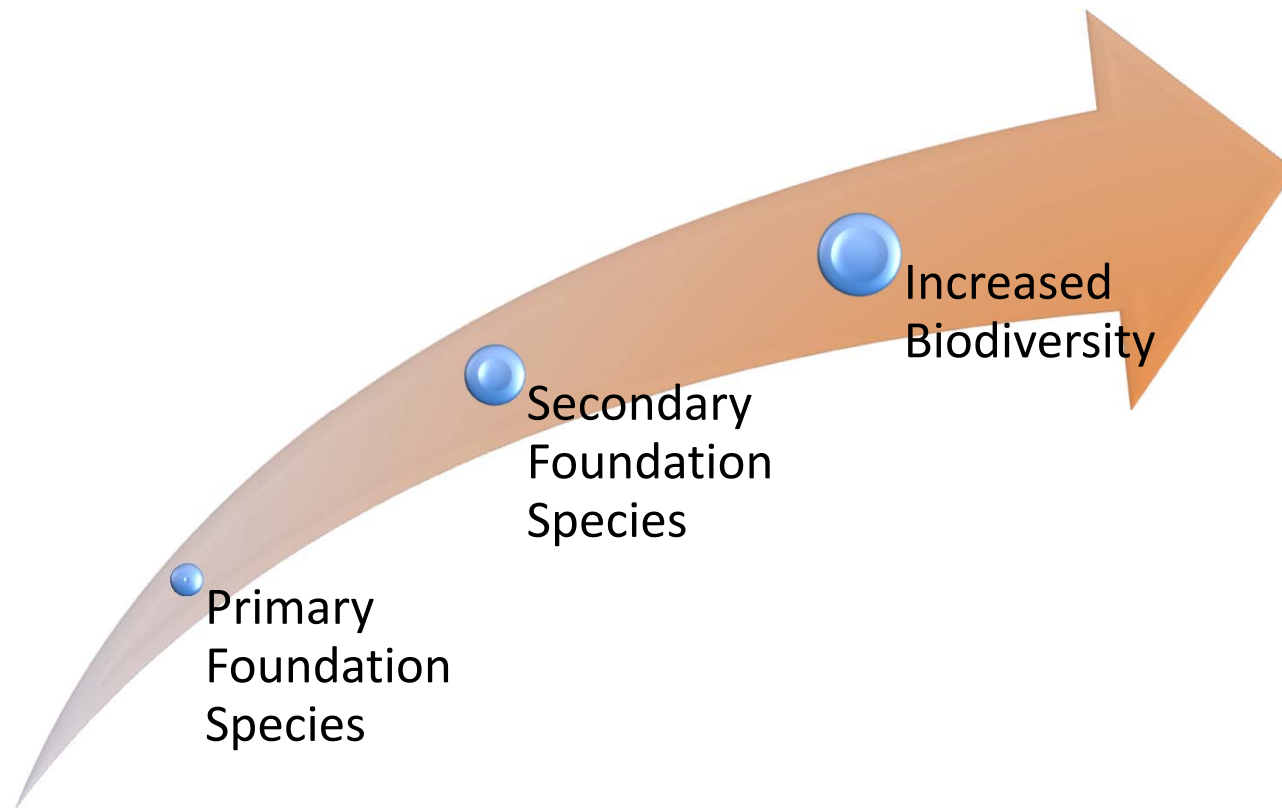

Angelini C, Silliman B (2014). Secondary foundation species as drivers of trophic and functional diversity: evidence from a tree-epiphyte system. *Ecology* 95(1):185-196

# Foundation Species Interaction – Biodiversity

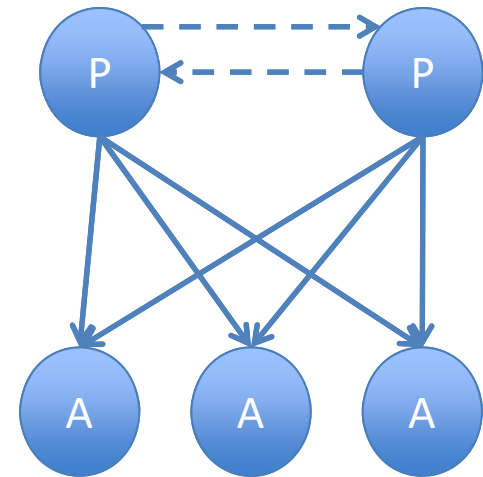
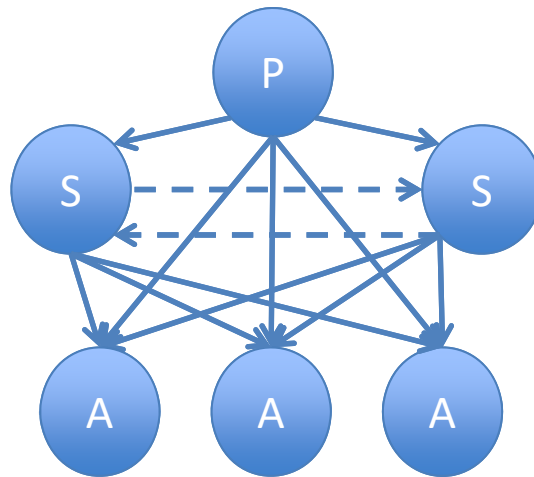
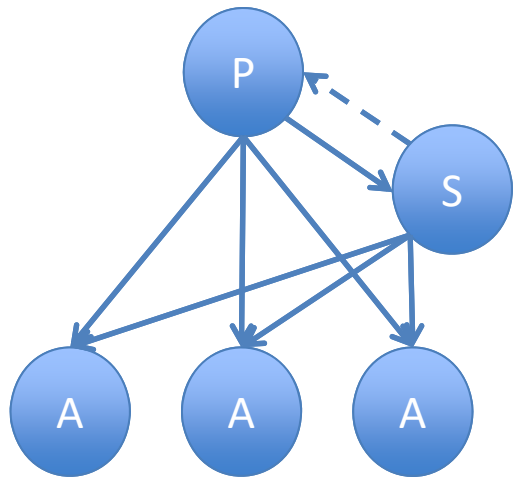
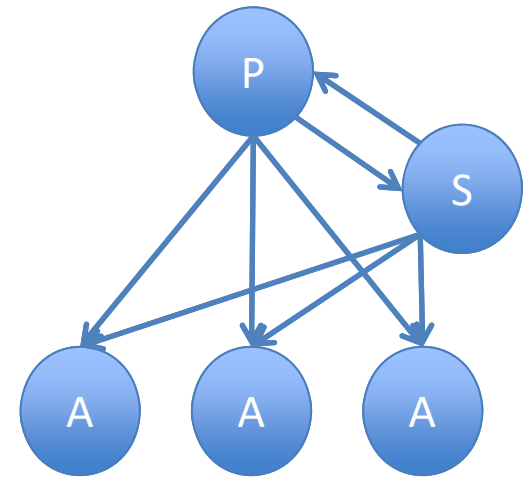
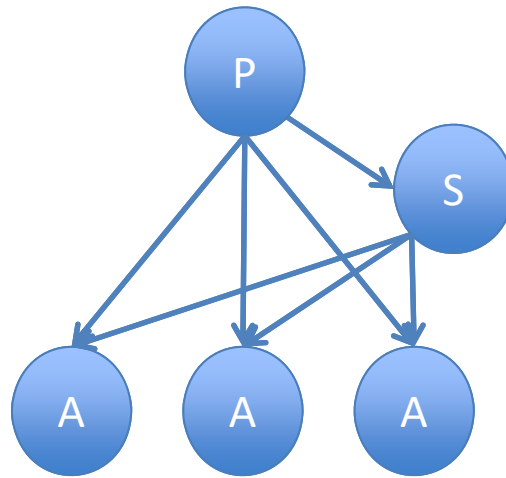
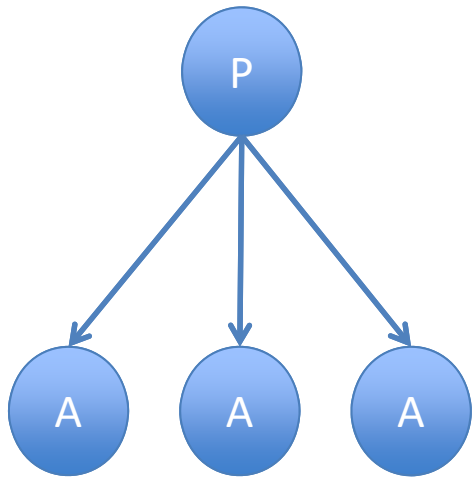

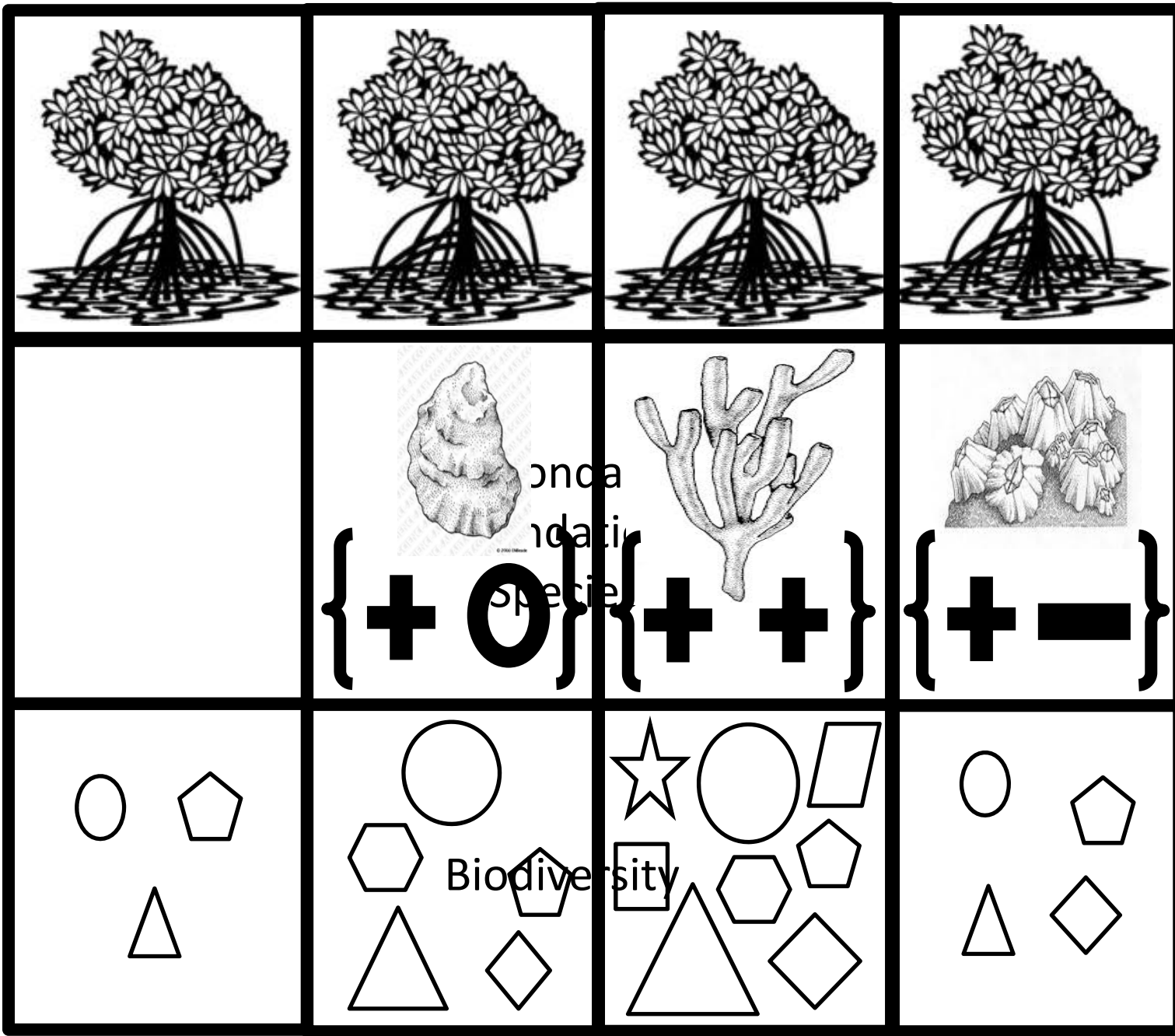

# Sessile Species Survey Sites

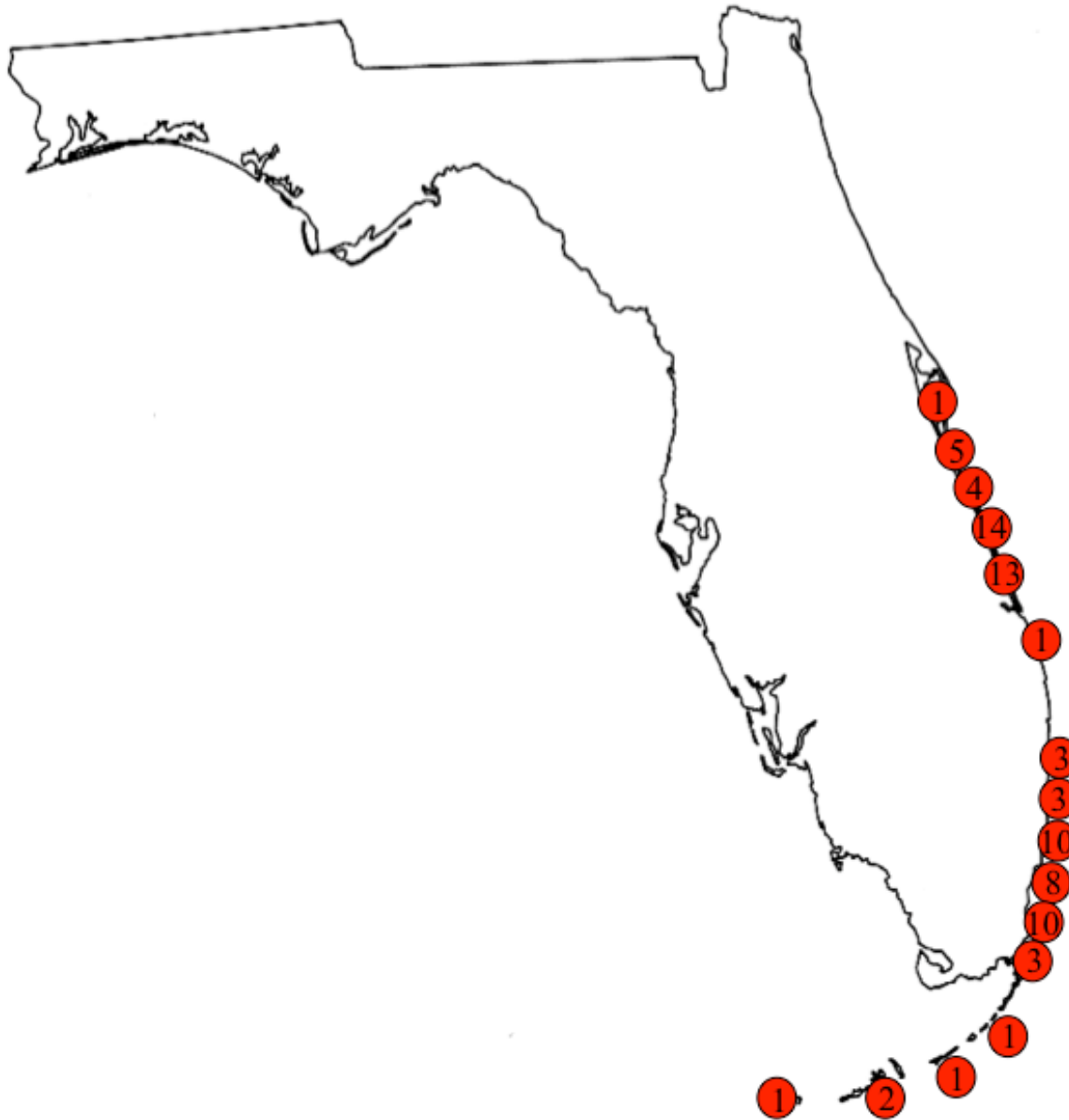



# Species Composition by Site

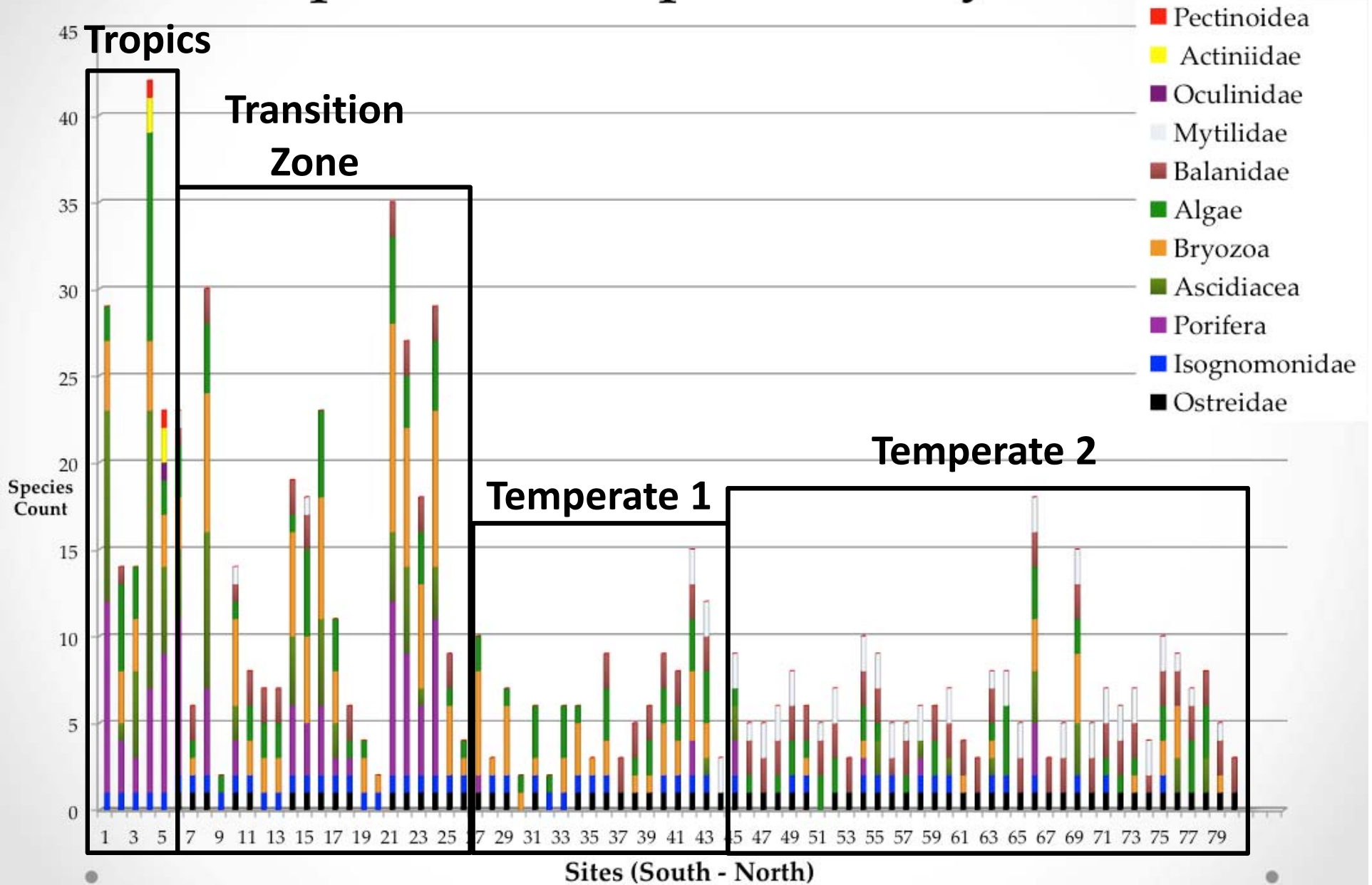

# Latitudinal Zones

- 4 Zones
- 3 sites per zone
- 10 trees per site

## Latitudinal Range of Zones

Brevard 27.51'58.55" – 28.47'7.69"

Martin-Indiana River 26.57'38.69" – 27.51'58.55"

Broward-Palm Beach 25.58'29.42" – 26.57'38.69"

Miami-Dade 25.17'4.61" – 25.58'29.42"

Florida Keys 24.32'42.84" – 25.17'4.61"

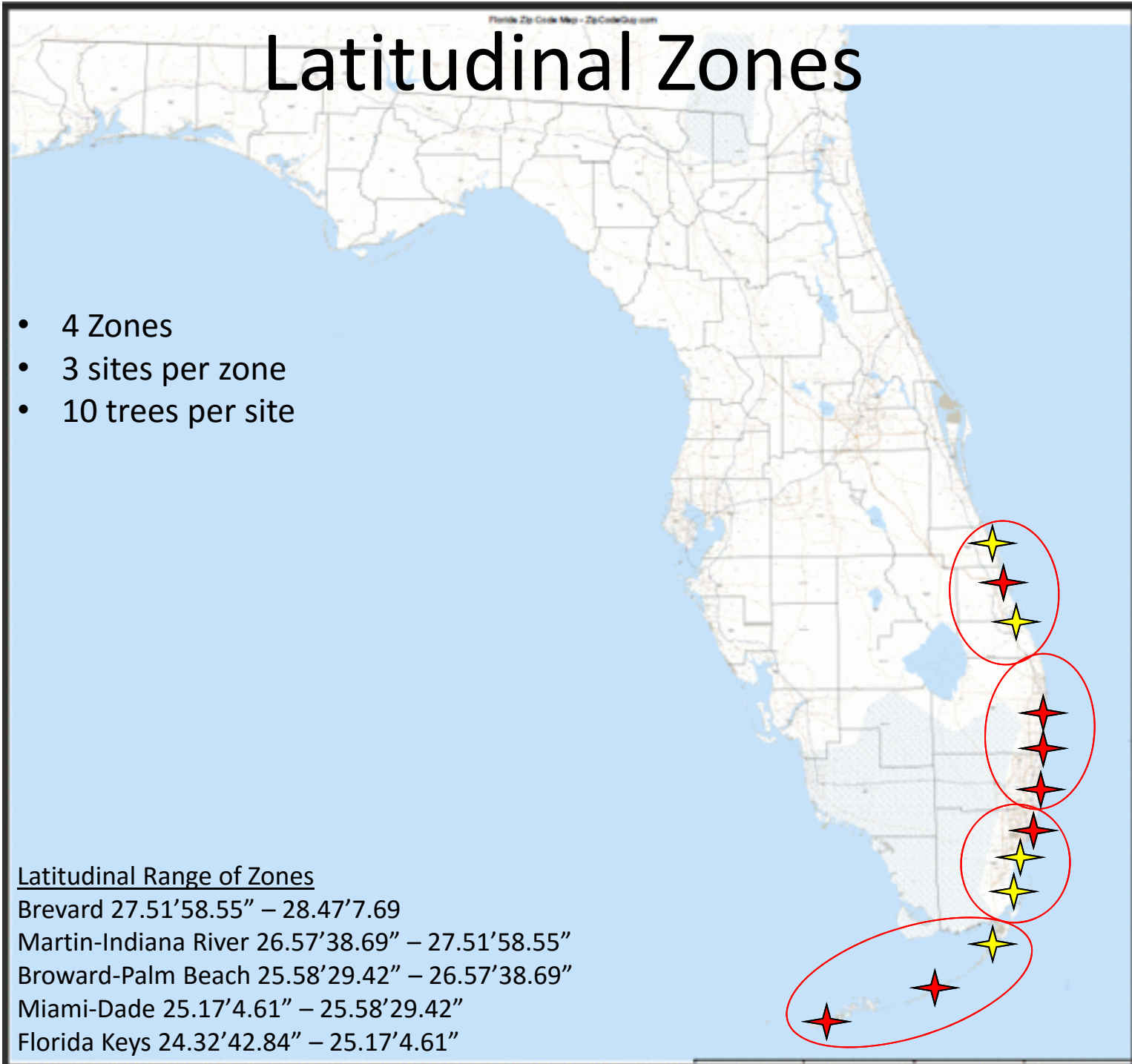

# Presence of Secondary Foundation Species

■ Sponge    ■ Oysters    ■ Barnacles

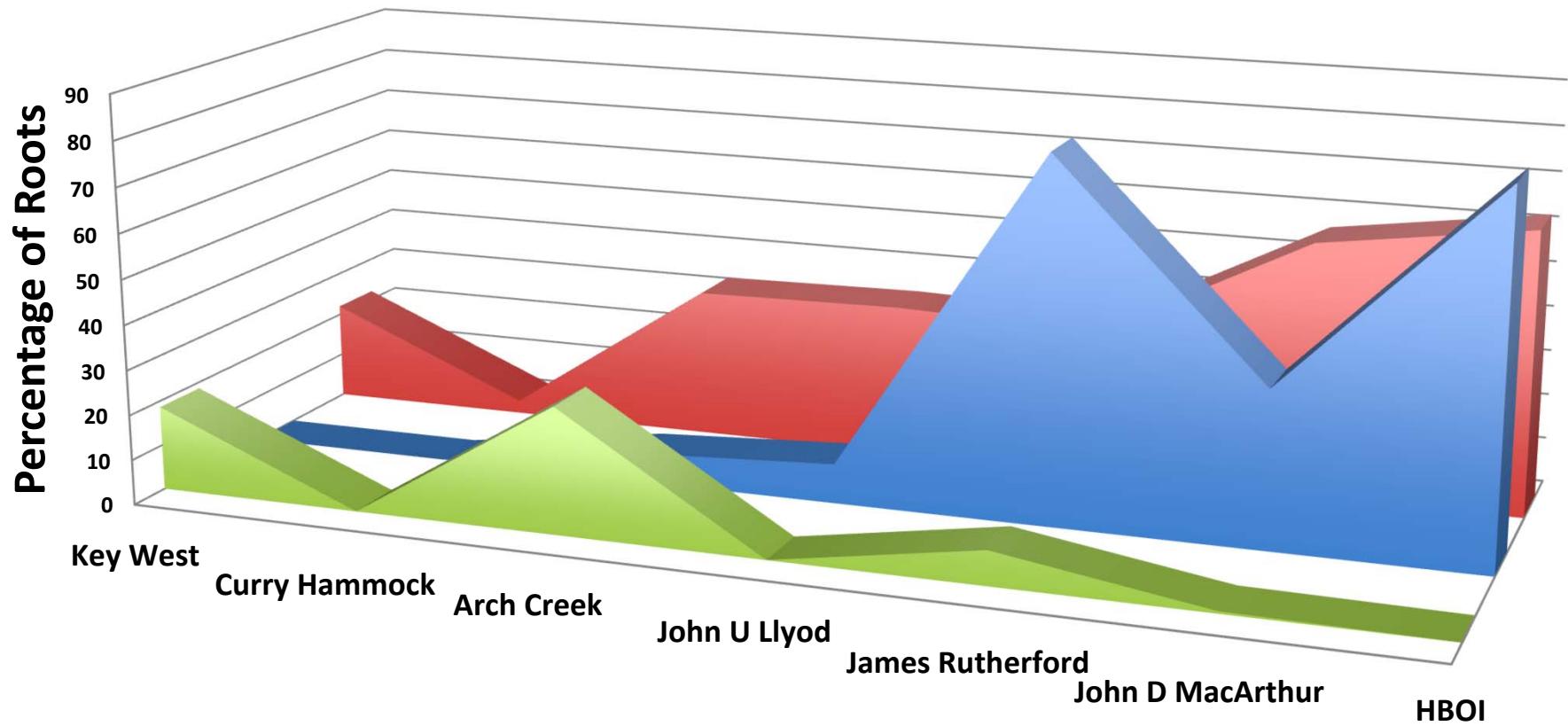

# Percentage of Prop Roots with Select Taxa

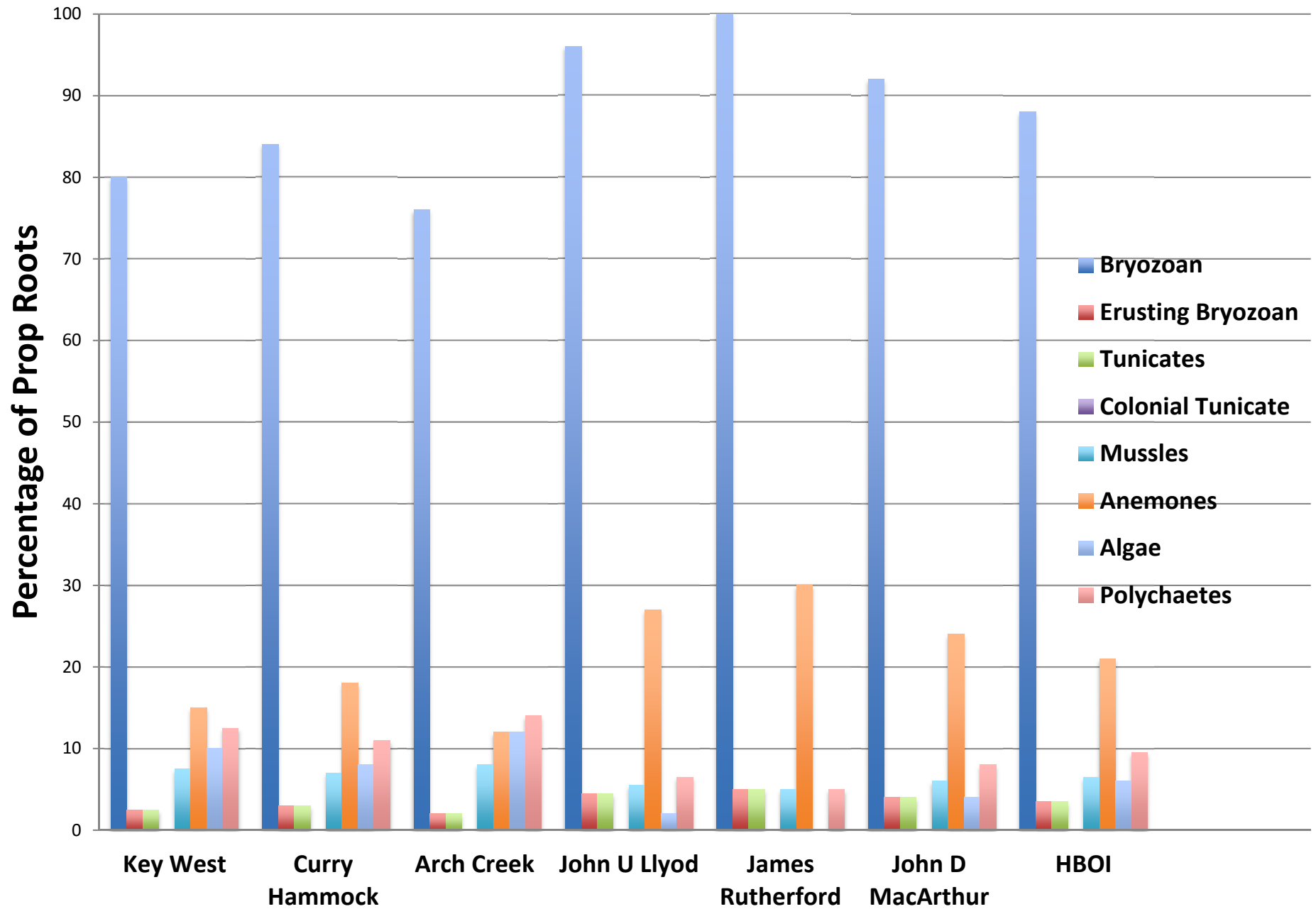

# Species Richness by Site

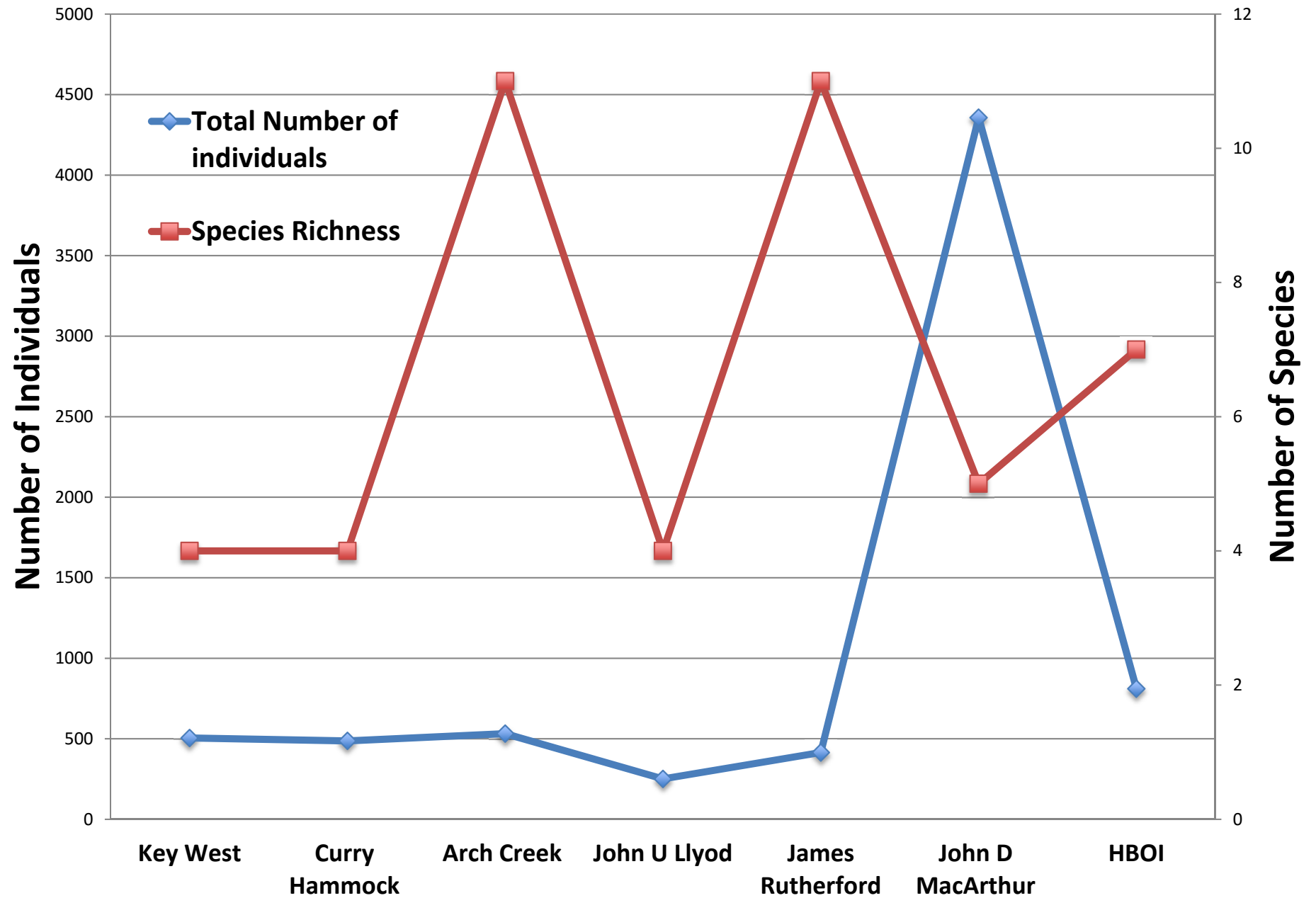

# Shannon-Weiner

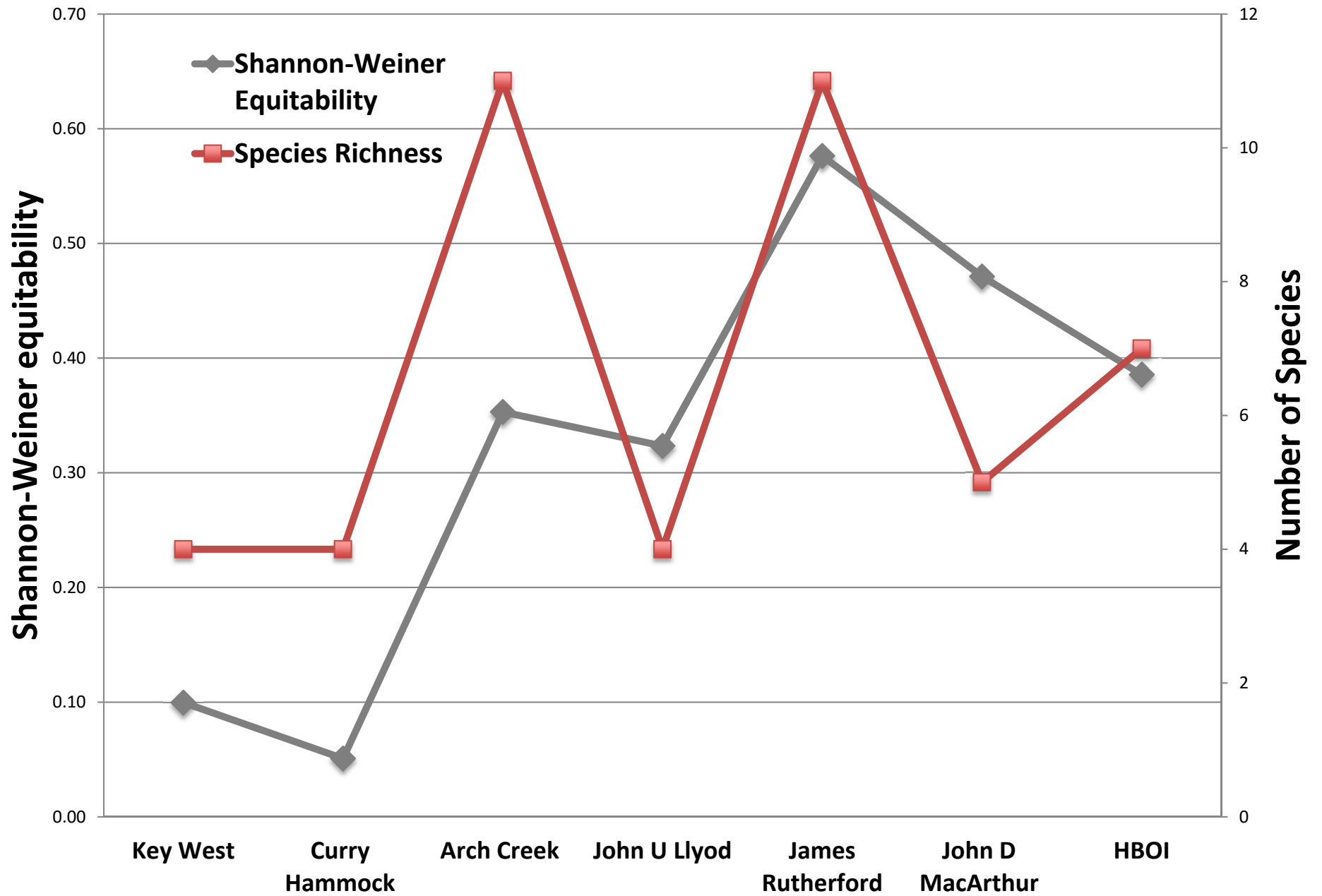

# Biodiversity

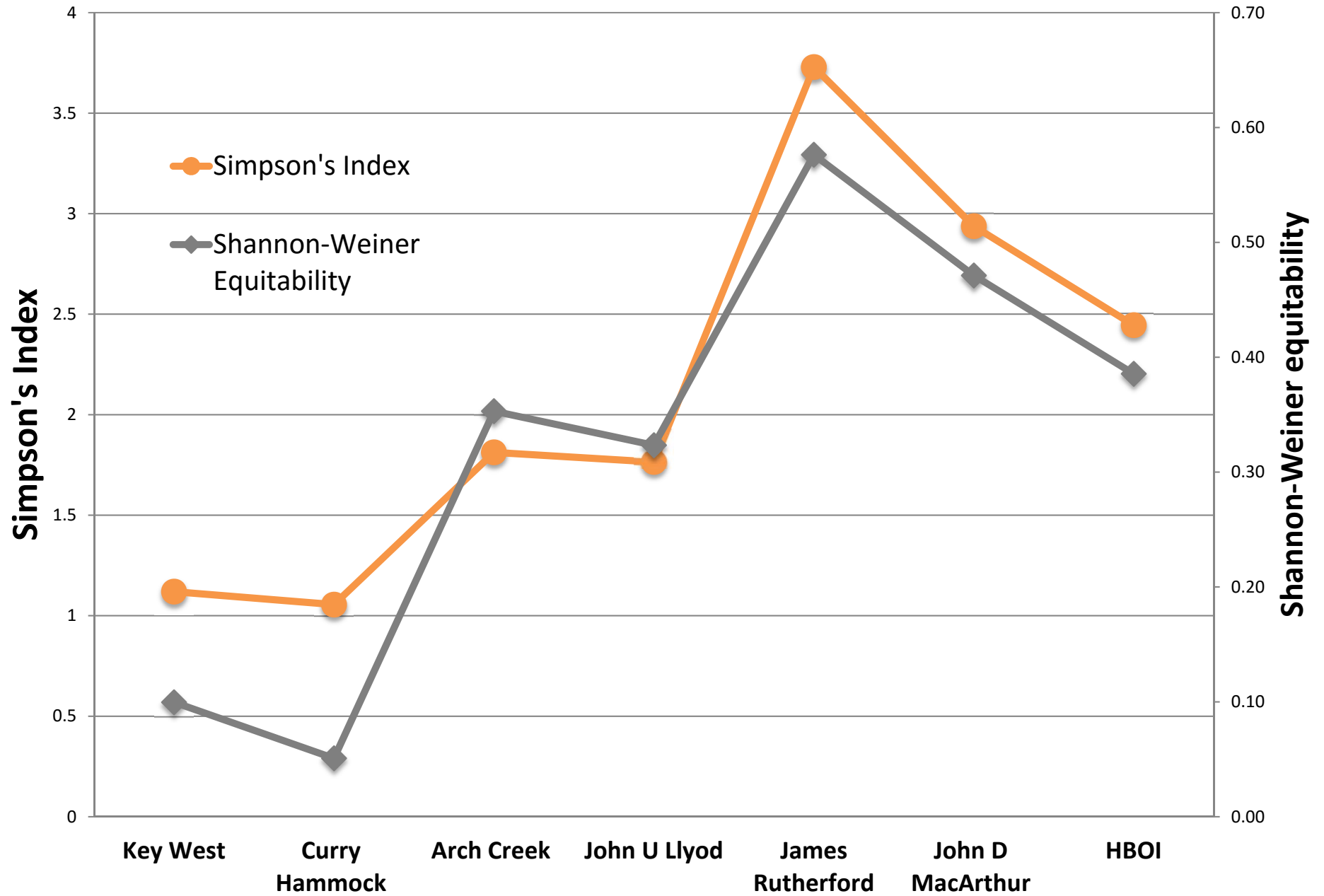

# Biodiversity

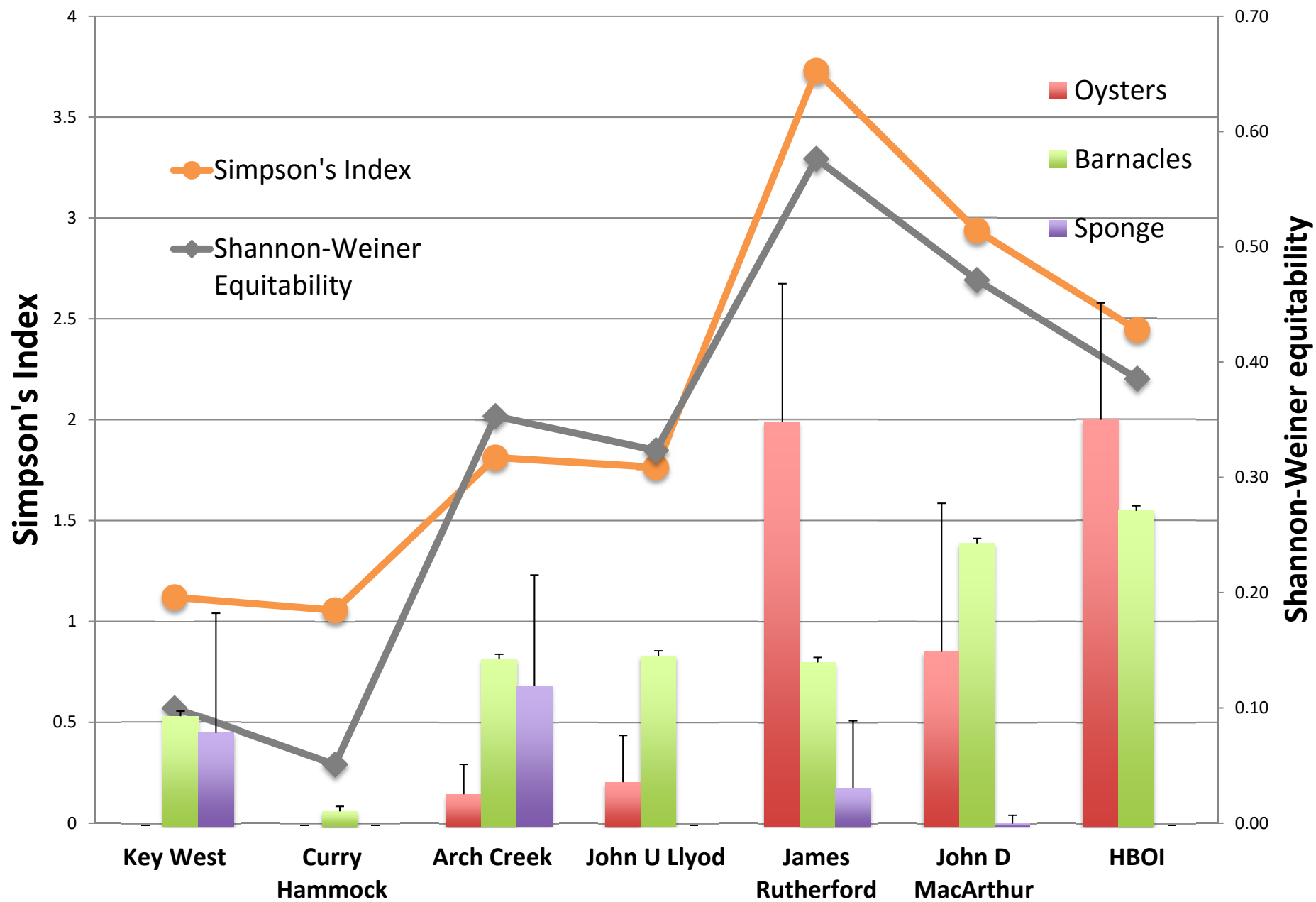



# Acknowledgements

## Funding Sources

Indian River Lagoon Graduate Fellowship

Smithsonian Internship

Delores A. Auzenne Fellowship

Florida Atlantic University Graduate Diversity

Boca Raton Orchid Society Endowed Scholarship

## Field Assistants

Shalondria Sears

Eric España

Christopher Ray

Andrea Carmona

Rachel Shanker

Chelsea Bennice

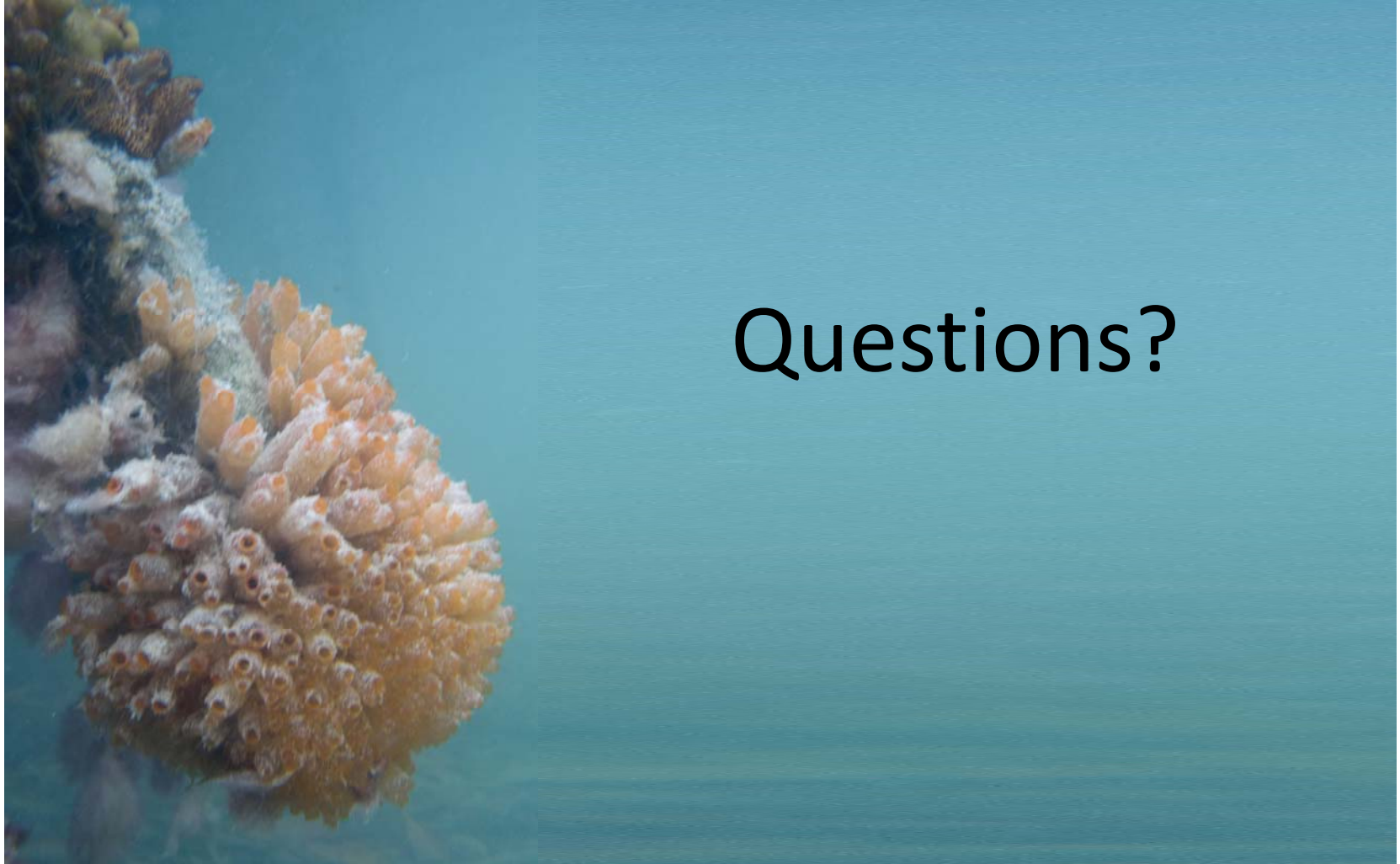

Questions?